

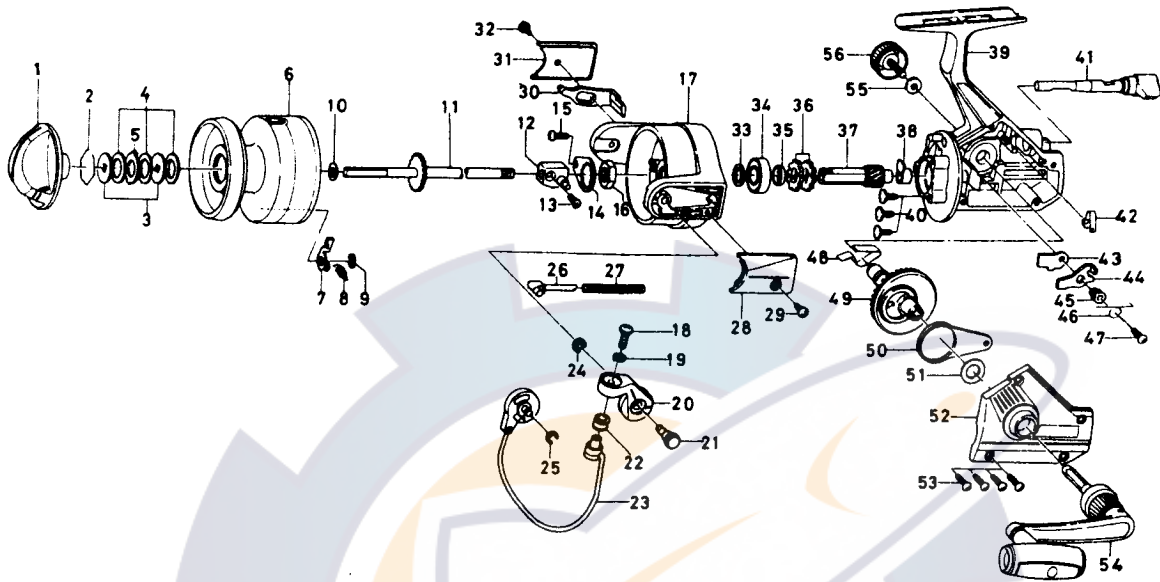

SPINNING REEL AG2600C/4000C



Key No.	Parts No.	Parts Name	Key No.	Parts No.	Parts Name
1	K 12-3902	Drag knob	33	371-2827	Bearing washer
2	171-7701	Drag washer retainer	34	K03-3601	Ball bearing
3	K06-7901	Key washer	35	K11-9501	Spacing sleeve
4	375-7802	Drag washer	36	K11-9401	Anti-reverse ratchet
5	B89-9501	Eared washer	37	K11-9301	Pinion gear
6	K06-7401	Spool assembly	38	K11-9201	Pinion holder
7	B07-8201	Click pawl	39	K06-6201	Body assembly
8	145-2101	Click spring	40	B84-2102	Bearing retainer screw
9	320-1402	Click retainer	41	K11-9001	Anti-reverse lever
10	374-9002	Spool washer	42	B58-8601	Anti-reverse cam spring
11	K06-6801	Main shaft assembly	43	K11-8601	Anti-reverse pawl plate
12	K12-1901	Oscillating slider	44	K11-8701	Anti-reverse pawl
13	352-0901	Oscillating slider screw	45	K11-8801	Anti-reverse pawl collar
14	B02-1601	Rotor nut holding plate	46	K11-8901	Anti-reverse pawl spring A
15	L01-1702	Rotor nut holding plate screw	47	K08-7802	Anti-reverse pawl screw
16	340-8301	Rotor nut	48	K12-1301	Anti-reverse pawl spring B
17	K12-5101	Rotor	49	K11-5801	Drive gear
18	353-9702	Line roller screw	50	K12-1801	Oscillating support
19	160-8101	Lock washer	51	371-2800	Drive gear washer
20	K06-6701	Bail arm	52	K06-8101	Side cover
21	K12-0401	Bail arm screw	53	K08-7801	Side cover screw
22	250-4221	Line roller	54	K06-8001	Handle assembly
23	K06-6301	Bail	55	L02-2301	Handle lock washer
24	320-1402	Bail arm screw retainer	56	L00-9102	Handle lock screw
25	320-1402	Bail trip cam screw retainer	AG4000C Special Parts		
26	K12-0601	Bail spring shaft	6	K06-7501	Spool assembly
27	K12-0701	Bail spring	17	K11-9701	Rotor
28	K12-0802	Bail spring cover	23	K06-6401	Bail
29	K07-1501	Bail spring cover screw	39	K06-6202	Body assembly
30	K11-9801	Bail trip lever	52	K06-8102	Side cover
31	K11-9902	Bail trip cover			
32	K07-1501	Bail trip cover screw			